

# For Sale - Vacant Land

Parcel Number 45033.0817

Spokane Valley, WA



## SPACE AVAILABLE

.91 Acres/39,695 S.F.

## SALE PRICE

\$395,000

## LOT INFORMATION

- Zoned MU (City of Spokane Valley)
- Live/work opportunity
- Prime location in the Pinecrot Business Park
- Adjacent to Centennial Trail Point and Spokane River
- Across from Mirabeau Park
- Close proximity to Valley YMCA, CenterPlace and Spokane Valley Mall
- Master Plan provides up-scale professional space with architectural continuity
- Located within the Irvin Water District, Avista Utilities, and East Valley School District

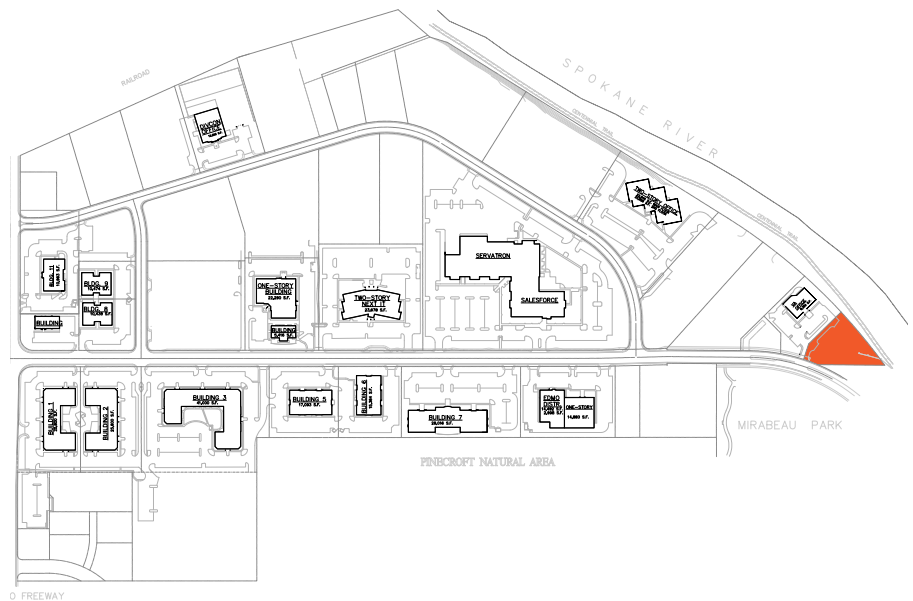

## CONTACT US TODAY

Leavitt Capital Companies, LLC  
12709 E. Mirabeau Parkway, Suite 10  
Spokane Valley, WA 99216

**Marc Mowrer**  
**509.714.6464**  
**Marc@Leavittcap.com**  
www.pinecrotbusinesspark.com



Property managed and leased by Leavitt Capital Companies, LLC. All information herein is furnished by the owner and believed to be complete and correct. The Agent, however, cannot be responsible for changes, errors, omissions or withdrawals of this offering without notice. The above information is from sources deemed reliable but should be verified by parties that could be adversely affected by any statements or information. This is not an offering of sub-agency, with commission splits to be determined.