

FOR SALE
18,094 SF Office/Flex/Warehouse
12539 E Pinecroft Way, Spokane Valley, WA



BUILDING SIZE

18,094 S.F.

PRICE

\$2,600,000 (\$144/SF)

AMENITIES

- Ideal for an owner-user looking for flex/warehouse space
- Anticipated delivery: Q1 2020
- Shell delivery: Grey shell
- Ceiling height: 20'
- Doors: 4 14'x14' overhead doors
- Yard: 1/2 acre paved yard area with the potential for expansion to 1+ acre
- Parking: 50 car parks
- Location: Proximate access to Trent and close access to I-90 off Pines exit

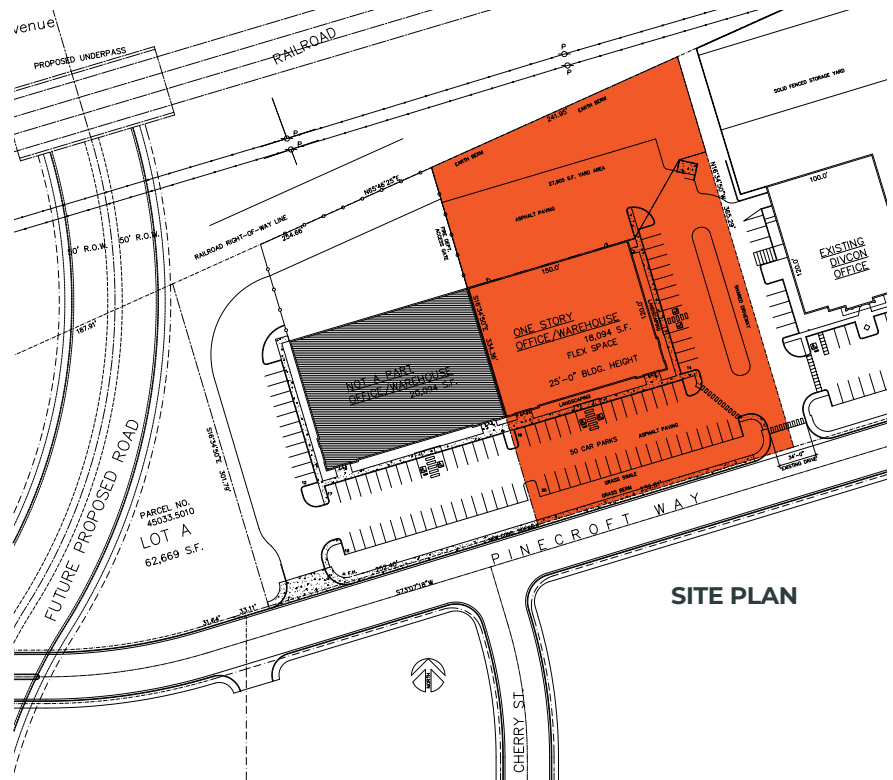

CONTACT US TODAY

Leavitt Capital Companies, LLC
12709 E. Mirabeau Parkway, Suite 10
Spokane Valley, WA 99216

Marc Mowrer
509.714.6464
Marc@Leavittcap.com
www.pinecroftbusinesspark.com



Property managed and leased by Leavitt Capital Companies, LLC. All information herein is furnished by the owner and believed to be complete and correct. The Agent, however, cannot be responsible for changes, errors, omissions or withdrawals of this offering without notice. The above information is from sources deemed reliable but should be verified by parties that could be adversely affected by any statements or information. This is not an offering of sub-agency, with commission splits to be determined.

FOR SALE
18,094 SF Office/Flex/Warehouse
 12539 E Pinecroft Way, Spokane Valley, WA

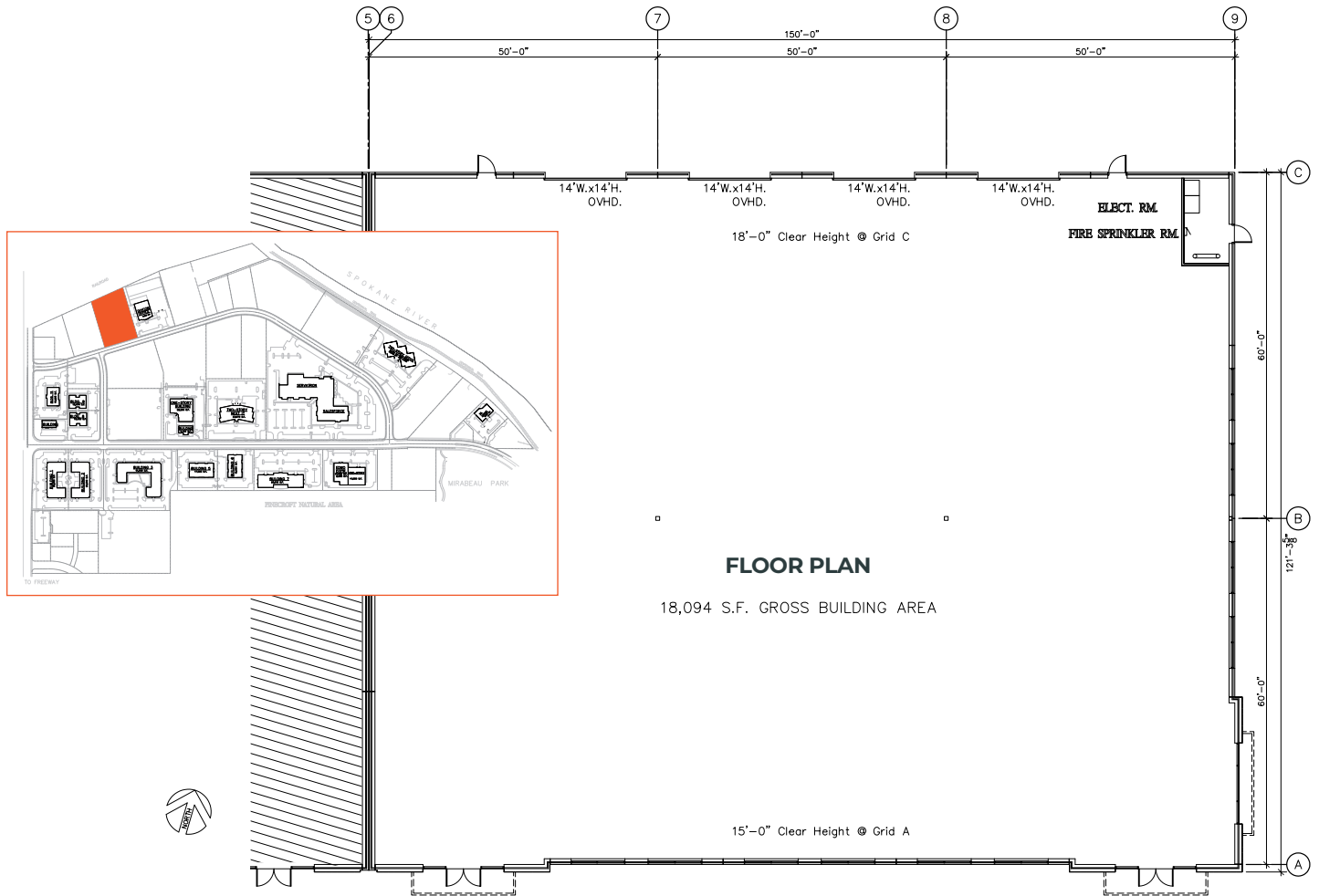

CONTACT US TODAY
 Leavitt Capital Companies, LLC
 12709 E. Mirabeau Parkway, Suite 10
 Spokane Valley, WA 99216

Marc Mowrer
509.714.6464
Marc@Leavittcap.com
www.pinecroftbusinesspark.com



Property managed and leased by Leavitt Capital Companies, LLC. All information herein is furnished by the owner and believed to be complete and correct. The Agent, however, cannot be responsible for changes, errors, omissions or withdrawals of this offering without notice. The above information is from sources deemed reliable but should be verified by parties that could be adversely affected by any statements or information. This is not an offering of sub-agency, with commission splits to be determined.