

For Sale - Vacant Land

Parcel Numbers 45102.9103 and 45102.0304
Spokane Valley, Washington



SPACE AVAILABLE

5.64 Acres/245,675 S.F.

SALE PRICE

\$1,050,000

LOT INFORMATION

- Zoned MU (City of Spokane Valley)
- Ideal for a multifamily use
- Close proximity to the Pinecrot Business Park, Centennial Trail, Mirabeau Park, Valley YMCA and Spokane Valley Mall
- Adjacent to Pinecrot Natural Area, providing a park-like setting
- Easy access to I-90 and STA bus routes
- Located within the Irvin Water District, Avista Utilities, and East Valley School District

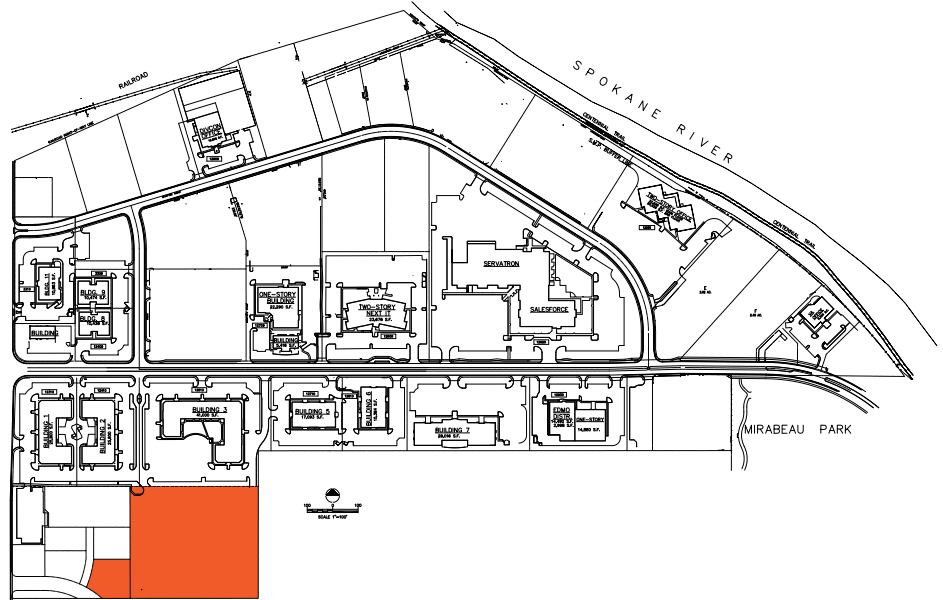

CONTACT US TODAY

JMA Commercial Real Estate, LLC
12709 E. Mirabeau Parkway, Suite 10
Spokane Valley, WA 99216

Office: 509.927.7747

Fax: 509.927.5989

Email: jma@jmacommercial.com

www.pinecrotbusinesspark.com



Property managed and leased by JMA Commercial Real Estate, LLC. All information herein is furnished by the owner and believed to be complete and correct. The Agent, however, cannot be responsible for changes, errors, omissions or withdrawals of this offering without notice. The above information is from sources deemed reliable but should be verified by parties that could be adversely affected by any statements or information. This is not an offering of sub-agency, with commission splits to be determined.